

MODERNISING THE CAMPGROUND WASTE TRANSFER STATION

WELCOME AND THANK YOU FOR COMING ALONG

Recycling and waste management company, SITA UK, is preparing to submit a planning application to Sunderland City Council to modernise the Campground waste transfer station in Wrekenton.

We are planning to transform the current site by:

- » Demolishing all the existing buildings.
- » Replacing the current waste transfer station with a new purpose-built facility.
- » Lowering the height of the buildings on site by around 10 metres.
- » Developing a new, environmentally friendly, on-site visitor and education centre.

We are holding this drop-in session so that you can find out more about our plans. By consulting at this stage, we hope to be able take your views into account as much as possible before we submit a full planning application towards the end of June 2011.

Please note: Images of the proposed facility at Campground used here are conceptual and may be subject to change.

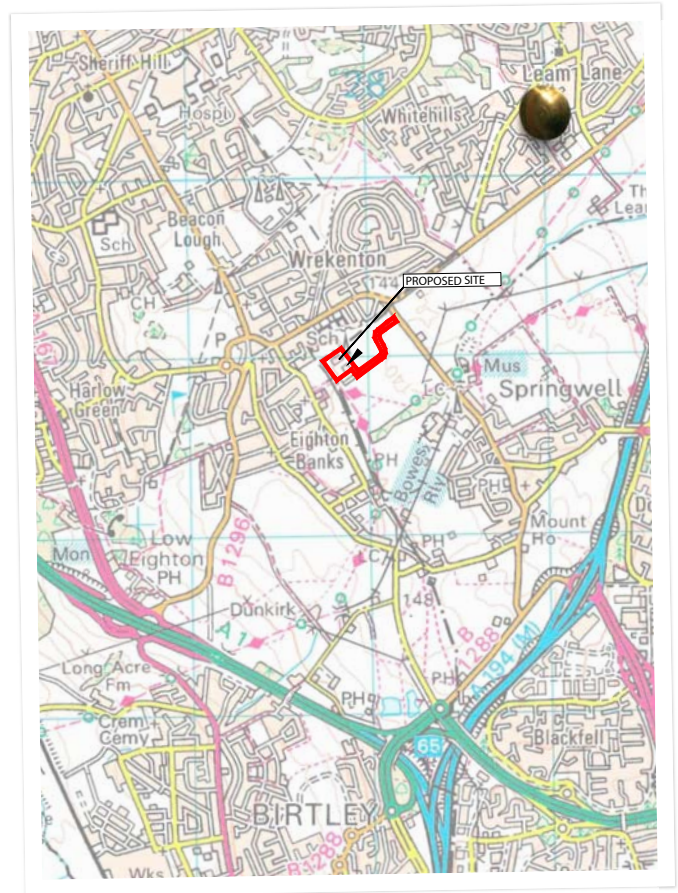

WHAT CURRENTLY HAPPENS AT CAMPGROUND WASTE TRANSFER STATION AND WHY ARE WE CHANGING IT?

Waste is collected from households and is taken to Campground on refuse lorries. This waste is then bulked up inside the transfer station and put onto larger lorries before it is taken to landfill. The waste transfer station reduces the number of lorry journeys that are needed.

The current site is outdated and in need of modernisation. By creating a purpose-built facility we can manage waste within an enclosed building, which means we can deal with up to 90,000 tonnes of waste in a controlled environment more effectively. Because all the waste will be handled in an enclosed environment, we will also be able to control noise and odours much more effectively.

The redevelopment of the transfer station is part of a new contract that SITA UK has with the South Tyne and Wear Waste Management Partnership.

The Partnership is made up of Gateshead and South Tyneside and Sunderland Councils and it has been formed to increase recycling rates and reduce the amount of household waste that is sent to landfill every year. Following a procurement process, SITA UK was appointed by the Partnership in 2011 to manage non-recycled waste over the next 25 years.



The current site at Campground



WHAT CHANGES ARE SITA UK PLANNING AT CAMPGROUND?

We plan to demolish all the old buildings on the site, some of which have not been used for 20 years. We will also replace the current waste transfer station with a new purpose-built facility.

This new enclosed and modern facility will allow lorries to transfer waste inside the building, rather than under the rubber sheeting which houses the operation at the moment. This means we can control noise and odours much more effectively.

We also want to develop a new visitor and education centre on the site so we can show visitors and school pupils how a modern waste transfer station works and encourage people to manage their own waste in a more environmentally friendly way.

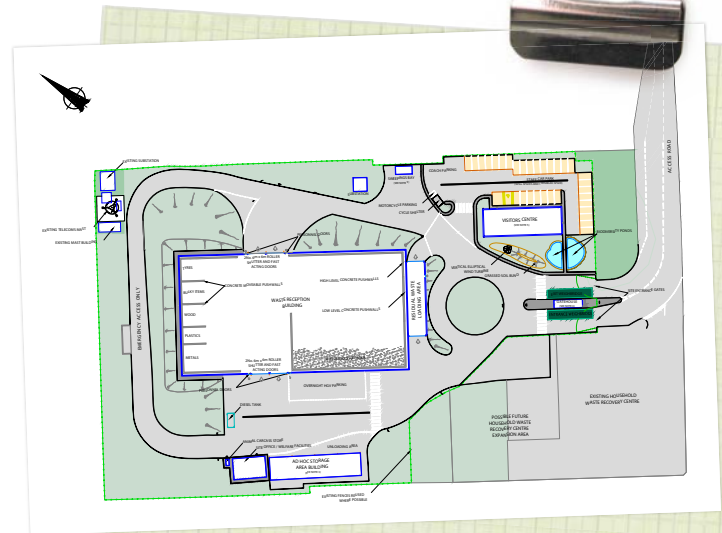

IMPROVEMENTS AT A GLANCE

- » The remains of old buildings will be demolished.
- » Lorries will transfer waste behind closed doors reducing noise levels.
- » A specially designed system will control odours inside the building.
- » The new education centre will be accredited by BREEAM – an environmental building awarding body.
- » Renewable energy will be generated on site by a small wind turbine and solar panels. This will help power the site.

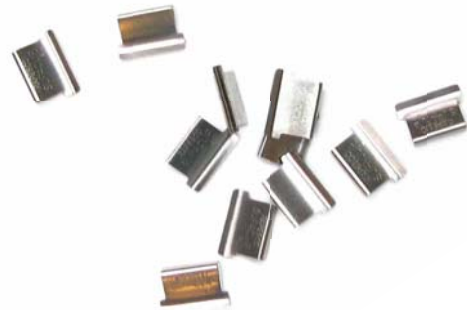

WHAT WILL THE NEW WASTE TRANSFER STATION LOOK LIKE?

The changes we are proposing will improve both the appearance and the way the facility at Campground operates.

One of the first improvements you will see is the removal of the old buildings. At its highest point, the new facility will reach 11 metres, compared to the highest current building on site which is 21 metres.

The new visitor and education centre will be made from sustainable materials. It will also be powered by solar panels, a small wind turbine and have a rainwater harvesting facility.

We will also create a pond to benefit wildlife and we will landscape the site to improve screening and encourage biodiversity.



Overview of the proposed site



View from entrance



WHAT WILL THE NEW WASTE TRANSFER STATION LOOK LIKE? (CONTINUED)



View from the back of the site



View of the visitor and education centre: the visitor and education centre will be made from sustainable materials with a glass and wood-panelled exterior.



HOW DOES A WASTE TRANSFER STATION WORK?

Transfer stations follow a simple process whereby non-recycled waste arrives at the site on lorries. This waste is then bulked up and transferred behind fast-action closing doors on to larger lorries before it continues its journey to an energy recovery facility or landfill site.

In this case, waste will be sent to our new energy-from-waste facility in Teesside, where the waste will be burned to produce electricity.

The transfer station at Campground helps the environment by reducing the number of lorry journeys taking waste to Teesside.

SITA UK operates 59 waste transfer stations across the UK.

HOW MANY VEHICLES WILL USE THE FACILITY?

A maximum of around 200 vehicles will travel to the facility each day. This includes lorry deliveries and people working at and visiting the site.



SITA UK's facility in Buxton



WHAT HAPPENS NEXT?

WE ARE KEEN TO HEAR YOUR VIEWS

We will use this feedback to determine our plans for the site before we submit our planning application to Sunderland City Council at the end of June 2011.

Please complete a feedback form and hand it to a member of staff, or contact us:

Telephone: **01628 513100** and ask for a member of the Communications Team

Email: **campground@sita.co.uk**

Address: **SITA UK, SITA House, Grenfell Road, Maidenhead, Berkshire SL6 1ES**

Thank you for coming along.



Turning waste into energy on behalf of



South Tyneside Council

